



### Key Functions

- Auto Exposure, Auto White Balance, Backlight Compensation
- Triple Stream (H.264, MJPEG) for simultaneous access to lo and hi resolution
- Onvif Profile S for compatibility with existing NVRs or software
- Easy Installation with IP Discovery software for Windows or Bonjour for Mac
- Full support for Internet Explorer, partial support for other browsers
- Advanced Intelligent Health Management automated diagnostic notification
- Event Boosting, FTP Image Upload, Open VPN, QoS, IP Filtering
- Privacy Masking with Face Detection
- Event Buffering for showing video prior to motion detection or other event

### Similar Models in this series

- **HTNC4300DM** 3 MP indoor micro dome, same 4:3 aspect ratio
- **HTNC4503M** (same as HTNC4503DM in bullet style housing)
- **HTNC5404M, HTNC5404DM** (4MP bullet and dome, 16:9 aspect ratio)
- **HTNC5803M, HTNC5803DM** (4K / 8MP bullet and dome, 16:9 aspect ratio)

### Software

- Includes free Titanium V2 256 camera viewing software for PC and Mac (requires MicroSD or Sharx Security NVR for recording, NVR recommended)
- Supports Milestone VMS (free for 8 cameras, any resolution, no time limit)
- Supports 16 Camera Blueiris on PCs, 16 camera SecuritySpy on Mac
- Supports Luxriot, Genetec, Aimetis, SightHound, OpenALPR, IPTimeLapse, VLC

### Optional Sharx Accessories

- **HWB** downward facing wall bracket, compatible with pole mount **HCPM**
- **HWB4** sconce type downward facing wall bracket, new style narrow mount
- **HPM** chandelier style ceiling pendant mount
- **HCB** indoor / outdoor conduit box, round, compatible with pole mount **HCPM**
- **HCPM** heavy duty pole mount / corner mount, requires **HCB** or **HWB**
- **HTCP2701:** PoE power + networking for up to 1.5 miles range over coax
- **HTNR16560:** 480 fps 16-camera 5 MP NVR (16 PoE), up to 24 TB storage
- **HTNR16621:** 480 fps 16-camera 4K NVR (16 PoE), up to 24 TB storage
- **HTNR32620:** 960 fps 32-camera 4K NVR (16 PoE), up to 48 TB storage
- **HTVM64600:** 1920 fps 64-camera 2/4/8 NVR link, up to 48 TB offsite storage
- **HTVM80600S:** 3840 fps 128-camera 2/4/8 NVR link, up to 96 TB offsite storage

### Dimensions

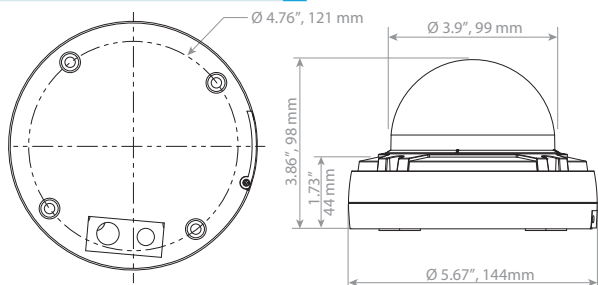

# Sharx HTNC4503DM

5 Megapixel Outdoor Day/Night Camera, Motorized 3x Zoom

### Key Features

- 5 Megapixel Resolution @ 15fps, 3 Megapixel Resolution @ 30 fps, Full HD @ 30 fps
- Motorized Varifocal 3.6 to 10mm Lens, Motorized 3 x optical zoom with smart focus
- Digital Wide Dynamic Range, True Day & Night
- 28 high power IR LEDs for up to 80 ft Night Vision Coverage in total darkness
- Connectors for Audio In/Out (1/1), Alarm In/Out (1/1)
- Solid metal construction, cable connection concealed in camera mount
- Mounts to wall, eave or ceiling with or without optional junction box HJB
- MicroSDHC card up to 256 GB (optionally available from Sharx Security)
- PoE, 12VDC (power supply not included,)
- **Suitable for US government applications - made in Korea without Huawei components**

### Technical Specifications

Model		Sharx Security HTNC4503DM - made in South Korea
<b>IMAGE</b>		
Lens	Motorized Varifocal Zoom 3.6~10mm, F1.5, built in Auto Iris	
Angle of View	95° (wide angle) to 40° (moderate telephoto), horizontal measurement	
Image Sensor	Type	1/1.8" SONY STARVIS CMOS Sensor
	Pixels	3096(H)x2080(V)
Min. Illumination	Color : 0.1Lux / BW : 0Lux@F1.5, 50IRE (IR LED On)	
Scanning Mode	Progressive Scan	
High Dynamic Range	Digital-WDR (Sony ATR-EX Adaptive Tone Reproduction)	
Day and Night Mode	True Day & Night (Auto, Day, Night)	
Noise Reduction	3DNR	
Digital Zoom	16X	
Exposure Control	Auto	
White Balance Control	Auto, Incandescent, Fluorescent, Outdoor	
Back Light Compensation	Yes	
Image Effect	Flip, Mirror, Aisle, Highlight Compensation, Distortion Correction	
Flicker Free Mode	50Hz, 60Hz	
Shutter Speed	Quantity	Auto(1/10,000 to 1sec), Manual
	Angle	28 IR LEDs, adjustable strength
IR Illuminator	Distance	80°(H)
	Motorized Lens Control	Yes, with SmartFocus or manual adjustment
<b>VIDEO/AUDIO</b>		
Compression	H.264(Baseline, Main, High Profile), MJPEG	
Bitrate Control	CVBR, VBR	
Resolution	2592x1944, 2560x1600, 2560x1440, 2048x1536, 1920x1080, 1280x1024, 1280x720/960, 1024x768, 704x480/576, 640x360/480, 320x240	
Frame Rate	Max 15fps @ 5 Megapixels, 30 fps @ 3 Megapixels or Full HD	
Streaming	Triple Stream : H.264x2, MJPEGx1	
Composite Out	No	
Audio Compression	AAC or G.711 (with user supplied external amplified microphone)	
Audio Streaming	2 Way (with user supplied external amplified speaker)	
<b>SYSTEM</b>		
Video Contents Analysis	Tampering, Line Detector, Field Detector	
Motion Detection Area	16 Programmable Area (8 Include Areas, 8 Exclude Areas)	
Special Features	Wide angle de-warp, Aisle Mode (90 / 270 rotation), 8 Privacy Zones	
Email Attachment or FTP Upload	JPEG	
Event Notification	E-mail, FTP, Notification Server, XML Notification, Audio Alert, AIHM	
Audio Alert	User-Defined 3 Audio Files	
Login Authority	Administrator, Operator, Guest	
Event Buffering	FTP	Pre : 30sec, Post : 30sec
	SD Record	Pre : 10sec, Post : 60sec
Manual Trigger	4 Programmable Triggers	
Security	Multi User Authority, IP Filtering, HTTPS & SSL (for admin/settings)	
Network Time Sync	NTP Server, Synchronized Computer, Manual	
Software Reset	Restart, Reset, Factory Default	
Hardware Factory Reset	Yes	
Auto Recovery	Backup, Restore	
Remote Upgrade	Yes	
SD Recording Mode	Event, Continuous	
<b>NETWORK</b>		
Protocol	TCP/IP, UDP, IPv4/v6, HTTP, HTTPS, QoS, FTP, UPnP, RTP, RTSP, RTPC, DHCP, ARP, Zeroconf, Bonjour	
Client Software	Internet Explorer, Titanium, Milestone, LuxRiot, Blueiris, SecuritySpy, VLC	
Max. User Connection	Live : up to 10 Users, Playback : up to 3 Users	
API Support	Open API, Onvif Compliance	
Mobile Support	Mobilinc, tinyCam, ONVIF compatible apps, free Titanium for use with NVR	
<b>EXTERNAL IN/OUT</b>		
Audio	1 Input, 1 Output(Terminal Block)	
Alarm	1 Input, 1 Output(Terminal Block)	
Ethernet	RJ-45(10/100Base-T)	
u-SD Card	MicroSDHC, MicroSDXC (Max 256GB, class 10 or faster)	
<b>ETC</b>		
Operating Humidity	0 to 100%RH (Weatherproof in rain, snow, ice conditions)	
Operating Temperature	-4 to +120 degrees Fahrenheit (-20 to +50 °C)	
Power Supply	PoE (802.3af compliance), 12VDC	
Power Consumption	180mA(8.5W)@PoE / 680mA(8.2W)@12VDC	
Dimension	5.67" / 144 mm(diameter) x 3.86" / 98 mm (height)	
Net Weight	Approx. 1.75 lbs (0.8 kg)	
Ingress Protection	IP66	



www.sharxsecurity.com  
info@sharxsecurity.com

Copyright © 2019 Sharx Security, Inc. All rights reserved.

Specifications are subject to change without notice.